

The RK Two piece Flanged ball valves feature a floating ball design for low-torque and increased cycle life. As a standard, the larger sizes feature a trunnion-style ball support to offer low-torque operation. The robust design of the F-Series ball valve is ideal for demanding, industrial applications.



FEATURES

- Split body design with flanged ends for fast installation, in-line maintenance and rebuilding.
- Solid ball construction provides structural integrity and minimizes flow turbulence.
- Bottom-loaded blow-out proof stem.
- Body joint is designed to prevent excessive compression of valve internals, resulting in consistent & low operating torque.
- Premium Quality PTFE Gland Packing and Seating.
- Optional vent porting.

Design And Manufacturing	: ASME B16.34
Pressure Rating	: Class 150 - 1500
Valve Face to Face Dimensions	: ASME B16.10
Flange Standard Conformity	: ASME B16.5
Inspection & Testing	: API 598 / ASME B16.34 / BS EN 12266-1
Mounting Pad	: ISO 5211

MATERIAL SPECIFICATION	
Body	A216 WCB / A351 CF8 / A351 CF8M IS 210 FG 260 / A536 65-45-12
Ball	A276 304 / A276 316 / A351 CF8 / A351 CF8M
Seat	PTFE
Stem	SS 410 / SS 304 / SS 316

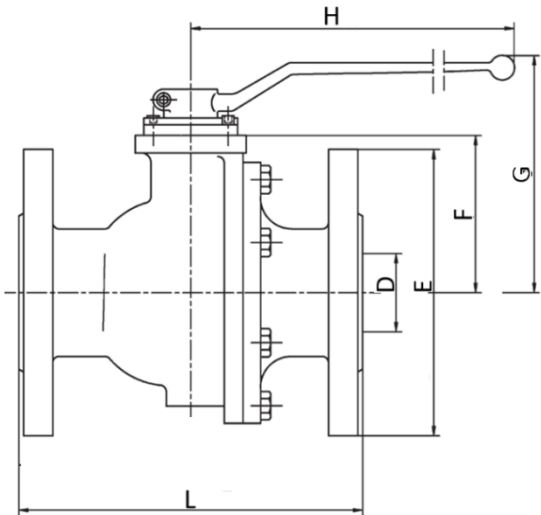

Dimensions for Class 150 & 300

Size		L		E		F	G	H
DN	NPS	150	300	150	300			
50	2	178	216	152	165	84	153	300
65	2.5	190	241	178	190	96	166	300
80	3	203	283	191	210	115	210	360
100	4	229	305	229	254	130	230	360
150	6	394	403	279	318	180	300	680
200	8	457	502	343	381	250	380	750
250	10	533	568	406	445	300	-	-
300	12	610	648	483	521	350	-	-

* Please consult our technical team for other materials, Actuators & Classes.