

2BV-T TWO PIECE BALL VALVE THREADED END

The RK Two piece threaded end ball valve provides bubble-tight shutoff upto 2500 class. This valve features threaded connections for easy installation. This valve features a standard locking lever handle for security. It may be used for isolation and throttling (half open to full open only).



FEATURES

- Threaded Ends.
- Full Bore, Two Piece Design.
- Quarter Turn, Lever Operated.
- Provided with Stainless Steel Ball/Brass.
- Premium Quality PTFE Gland Packing and Seating.

Design And Manufacturing	: ISO 17292
Pressure Rating	: Class 150 - 2500
Valve Face to Face Dimensions	: ASME B16.10 / Manufacturer
Flange Standard Conformity	: ASME B16.25
Inspection & Testing	: ISO 5208 / API 598 / BS EN 12266-1

MATERIAL SPECIFICATION	
Body	A126 B / A216 WCB / A105
	A351 CF8 / A351 CF8M
	IS 318 GR. LTB 2 (Bronze) / IS 6912 Gr. FLB (Brass)
Ball	A276 304 / A276 316 / A351 CF8 / A351 CF8M
	IS 6912 Gr. FLB (Brass)
Seat	PTFE
Stem	SS 410 / SS 304 / SS 316

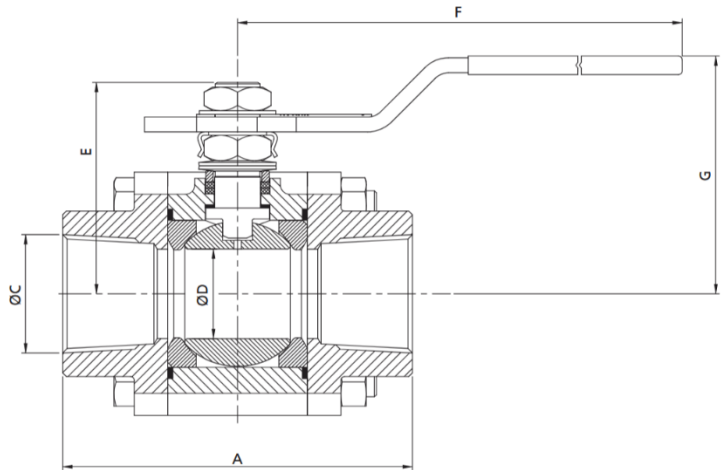

Dimensions for Class 150

Size		A	B	C		D	E	F	G
DN	NPS			BSPT	NPT				
8	1/4	62	9.5	1/4 - 19	1/4 - 18	11	38	132	50
10	3/8	62	9.5	3/8 - 19	3/8 - 18	11	38	132	50
15	1/2	66	10	1/2 - 14	1/2 - 14	11	38	132	50
20	3/4	75	13	3/4 - 14	3/4 - 14	17	46	132	58
25	1	92	13	1 - 11	1 - 11 1/2	24	54	162	65
32	1 1/4	114	13	1 1/4 - 11	1 1/4 - 11 1/2	37	75	192	83
40	1 1/2	114	13	1 1/2 - 11	1 1/2 - 11 1/2	37	75	192	83
50	2	132	16	2 - 11	2 - 11 1/2	49	87	202	94
65	2 1/2	185	16	2 1/2 - 11	2 1/2 - 8	62	200	390	200

* Please consult our technical team for other materials, Actuators & Classes.