

RK Single plate wafer check valve is also known as a wafer check valve, single disc check valve, or swing check valve. A single-plate check valve is designed for return flow prevention in pipeline installation which is simple in construction, compact, light-weight, sturdy & rugged. Wafer check valve can operate effectively in both vertical & horizontal pipe lines. It has long life & trouble-free operation. Single plate wafer check valve is also cost competent as it is easy to handle, pack and transport.



FEATURES

- Soft seated valves come in two variants – O ring seated and PTFE / RPTFE seated.
- Wafer type end connections as standard – other types can be provided on request.
- Extremely low opening pressures.
- Low pressure drops: Decreasing with increasing valve size.

Design And Manufacturing	: API 6D / ASME B16.34
Pressure Rating	: PN 10 / PN 16 / ANSI 150
Face to Face Dimensions	: Mfg. Standard
End Connection	: Wafer Type
Inspection & Testing	: API 598 / ASME B16.34 / BS EN 12266-1

MATERIAL SPECIFICATION		
1	Body	Ductile Iron / WCB / CF8 / CF8M
2	Seat	Metal-to-Metal, EPDM, VITON, BUNA-N, NEOPRENE, PTFE
3	Disc	Ductile Iron / WCB / CF8 / CF8M
4	Bolt	SS
5	Hinge Pin	SS304 / SS316
6	Lifting Hook	SS304 / SS316

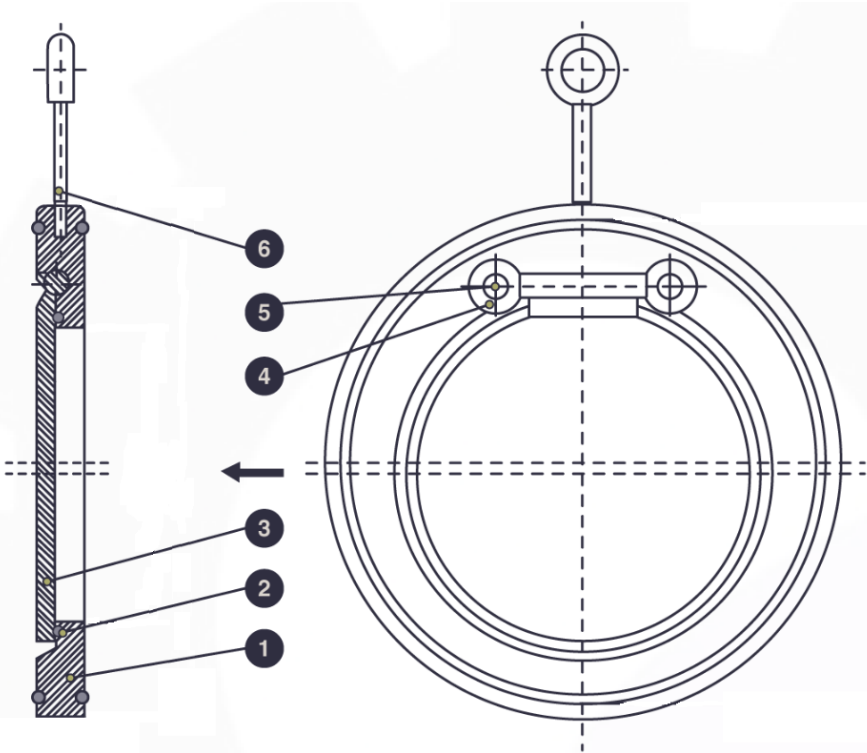

Dimensions for PN10 / PN16 / Class 150

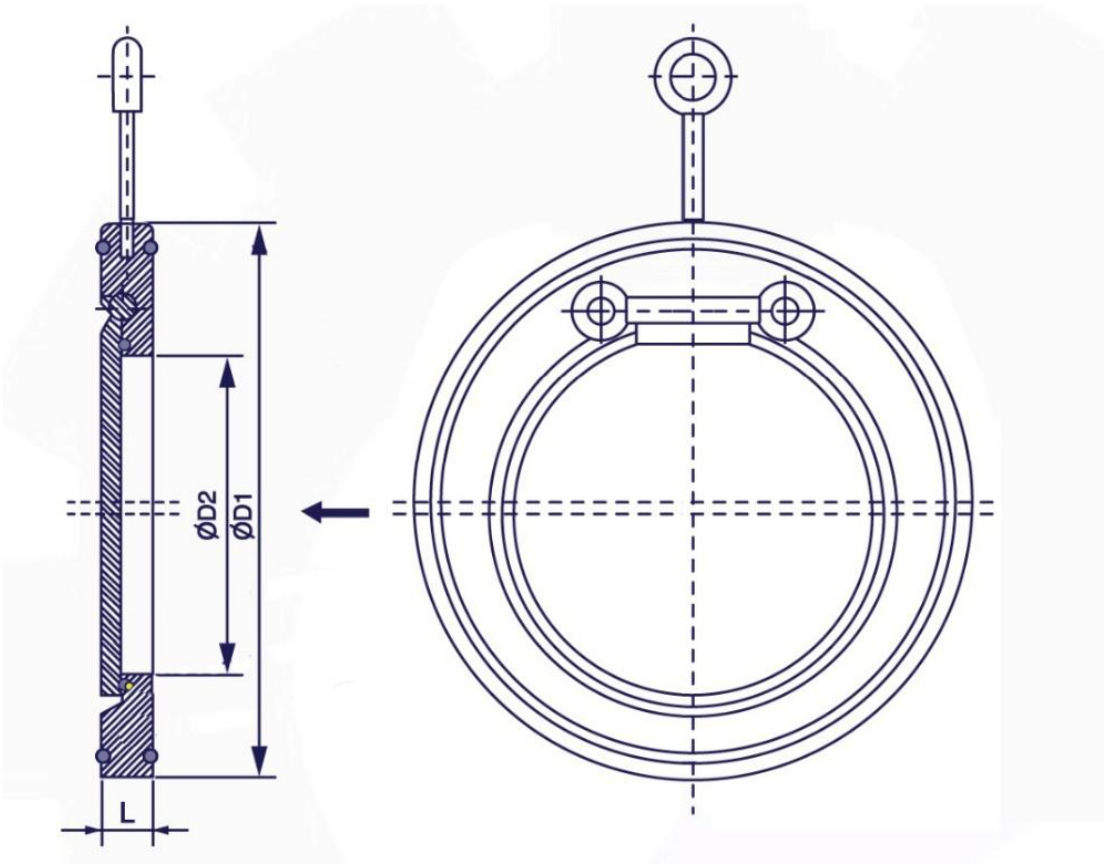

Size		$\varnothing D2$	L	$\varnothing D1$		
DN	NPS			PN 10	PN 16	ANSI 150
25	1	14	19	72	72	64
40	1 1/2	22	19	93	93	86
50	2	30	19	108	108	104
65	2 1/2	40	19	128	128	123
80	3	52	19	143	143	136
100	4	71	19	163	163	174
125	5	95	19	193	193	196
150	6	114	19	219	219	221
200	8	157	28.5	274	274	278
250	10	195	28.5	329	329	339
300	12	230	38	379	385	409
350	14	270	44.5	438	444	449
400	16	310	51.0	489	496	512
450	18	360	60.5	538	555	545
500	20	406	63.5	593	696	605
600	24	490	70.0	695	799	714

\* Please consult our technical team for other materials, Actuators & Classes.